



PETCO

Heavy Duty Pumps & Water Turbine Mfg. co.

Flexible Coupling with Spacer
PFC Serieese



PFC

Model

Flexible Coupling With Spacer

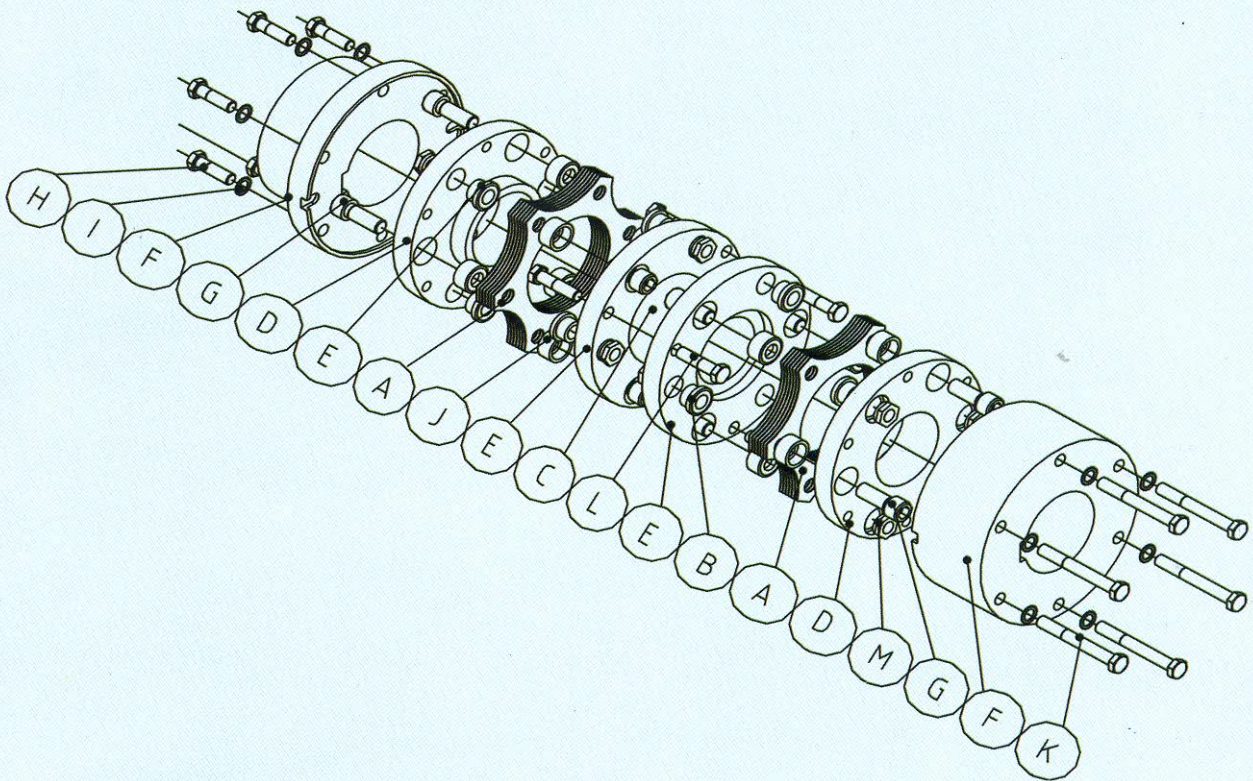

A: Flexible Membrane

B: collar Bush

C: Spacer

D: Middle Flange

E: Spacer Flange

F: Hub

G: cylinder Head Cap Screw

H: Hex Head Bolt

I: Lock Washer

J: Neck Bush

K: Hex Head Bolt

L: Hex Head Bolt

M: Nut



Model

Flexible Coupling With Spacer

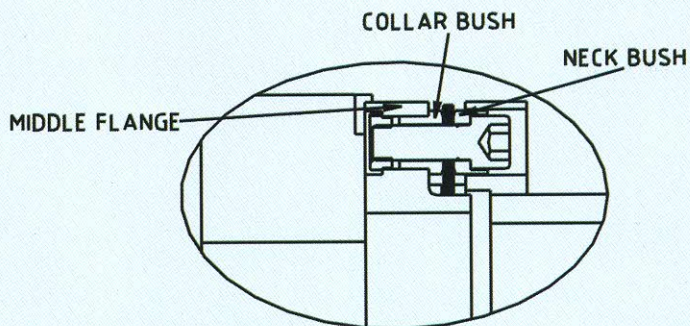
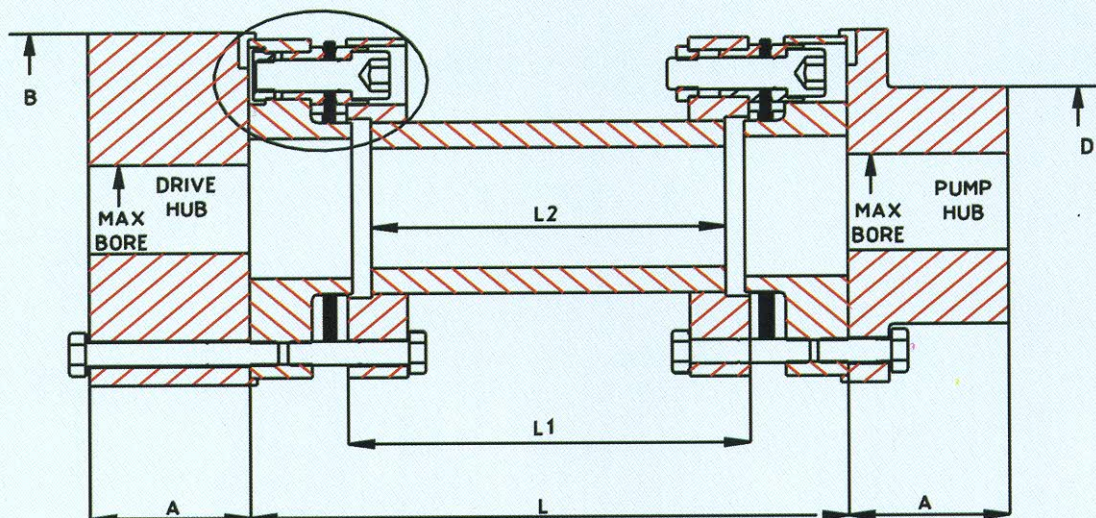

Dimension and Specification

Coupling Size	A	B	L	L1	L2	L	L1	L2	L	L1	L2	D	Drive Hub*	Pump Hub*
PFC 0013	40	86	100	60	46	125	85	71	140	100	86	54	36	51
PFC 0075	55	130	125	69	53	140	84	68	200	144	128	90	65	90
PFC0135	62	152	140	74	60	250	184	170				112	80	102
PFC 0230	67	179	240	158	138							120	90	121
PFC0350	87	197	250	142	122							150	115	-
PFC 0500	95	222	267	153	133							154	127	-
PFC 0930	115	272	250	148	118							205	155	-
PFC 1400	130	297	280	150	126							210	172	-

* Maximum bores shown are based on standard DIN/BS rectangular keys.

PFC

Model

Flexible Coupling With Spacer

- A: Flexible Membrane
- B: Collar Bush
- C: Spacer
- D: Middle Flange
- E: Spacer Flange
- F: Hub
- G: Cylinder Head Cap Screw
- H: Bolts

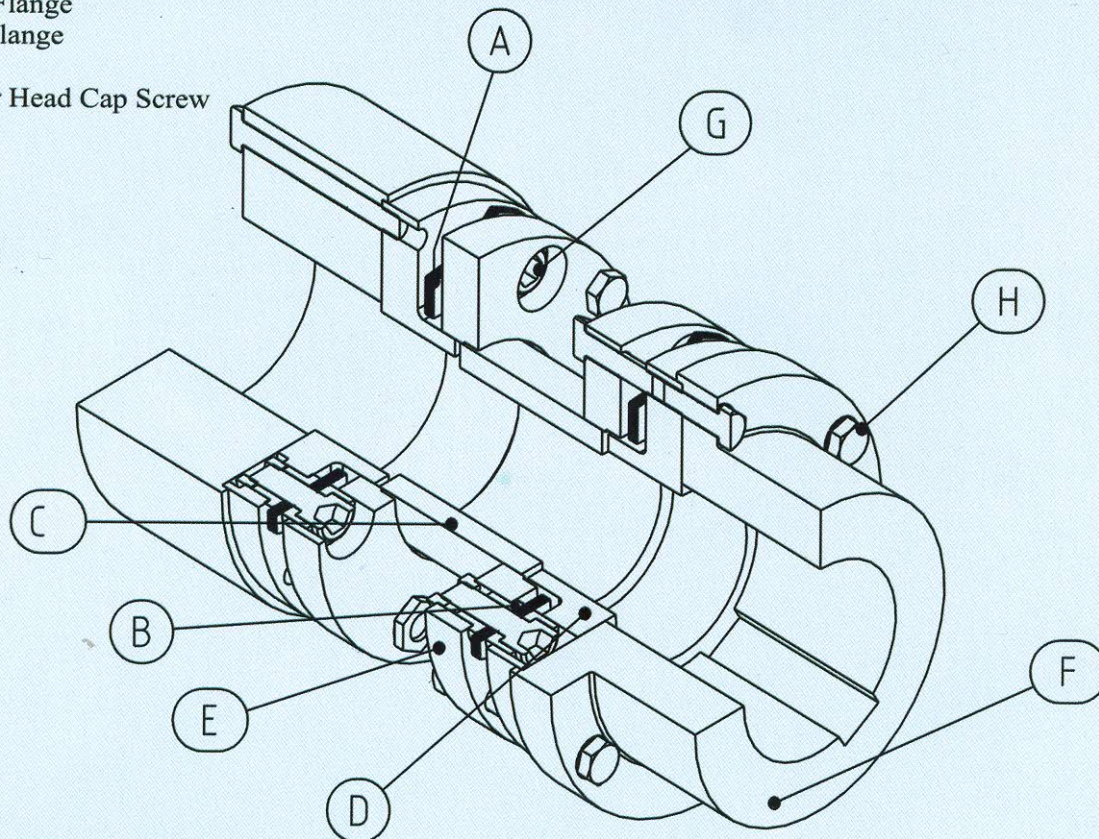

ADVANTAGES :

- Easy to fit .
- Acc. to API 671 , API 610 standards.
- Acc. to AGMA class 9.
- Suitable for electric motor and turbine drivers.
- Execlent power-to-weight ratio.
- High misalignment capability.
- Reduced machinery vibration.
- Maximised bearing life.
- Stainless steel flexible membranes for maximum life.
- Anti-fly retention of the spacer in the unlikely event of membran failure.